

How to connect eduroam in Windows 10

1. From the Windows 10 Start screen or the Desktop
 - Locate the Wireless icon in the task bar (bottom right corner)
 - Click on the Wireless icon

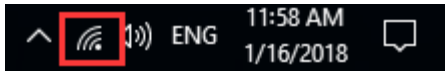

2. A list of connections will be displayed
 - Ensure the WIFI coverage

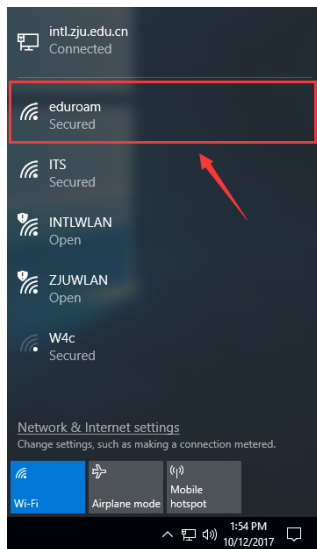

3. Search control panel in the menu bar and enter 'Control Panel'

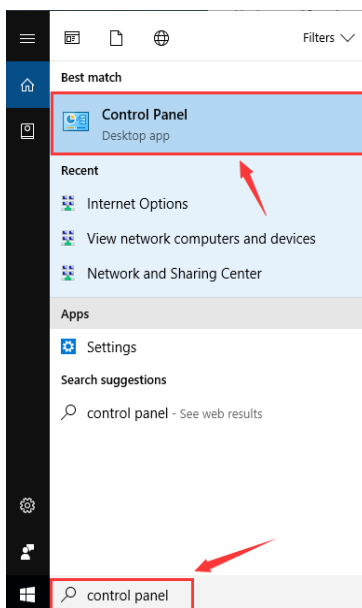

4. Select 'Network and Internet' in 'Control Panel'

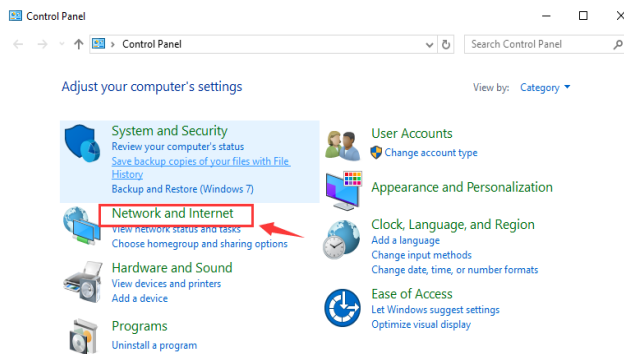

5. Select 'Network and Sharing Center' in 'Network and Internet'

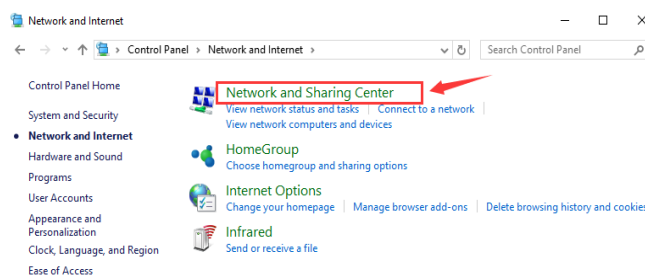

6. Select 'Set up a new connection or network' in 'Network and Sharing Center'

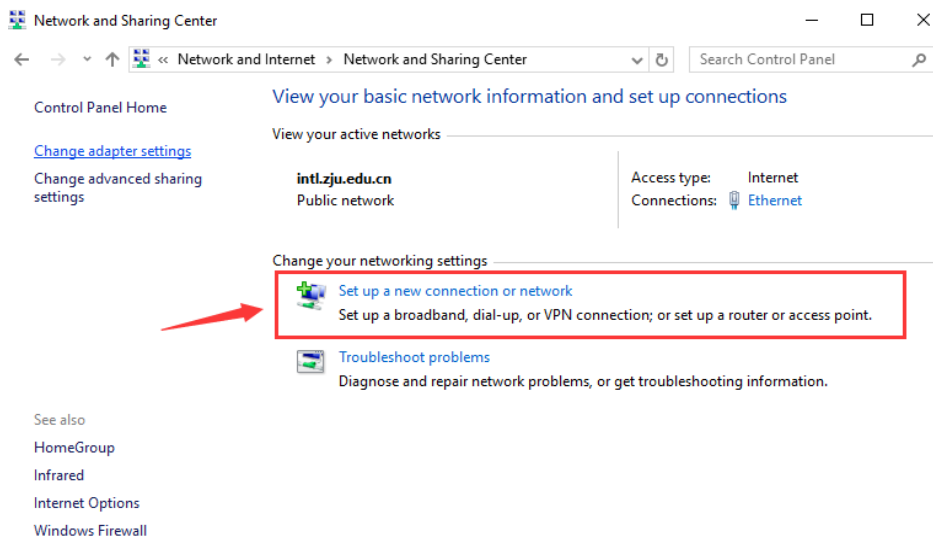

7. Select 'Manually connect to a wireless network'

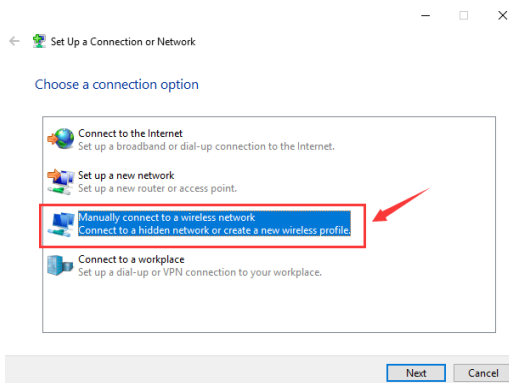

8. Change the Network name to eduroam, change Security type to WPA2-Enterprise

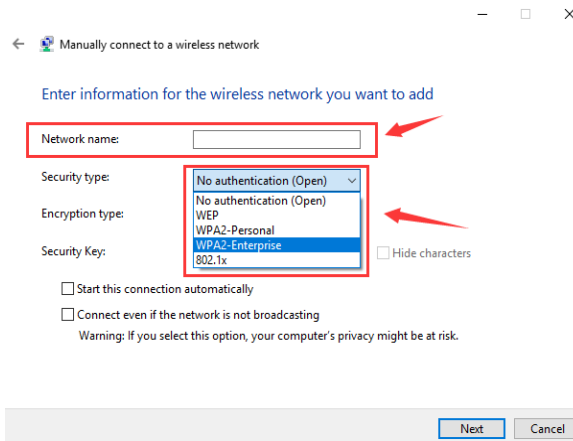

9. Select 'Change connection settings'

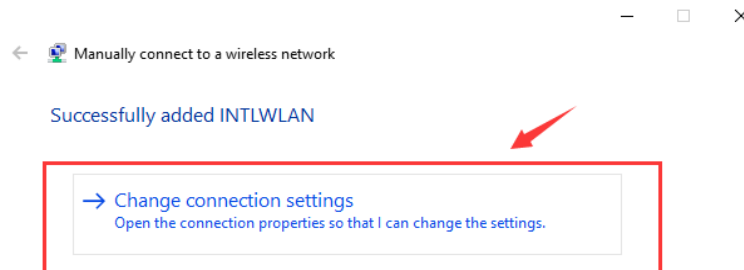

10. Select 'Security' and choose 'Settings'

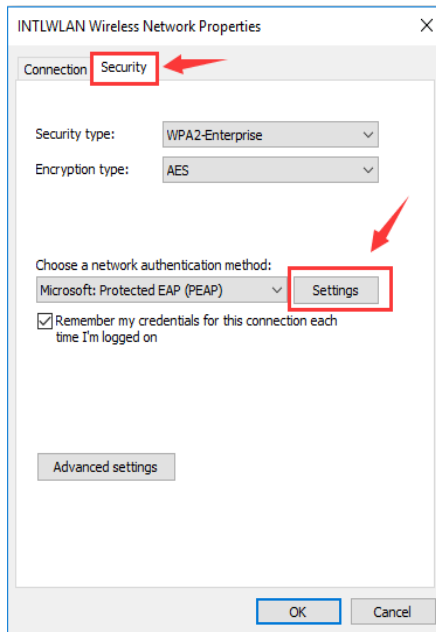

11. Cancel the '√' of 'Verify the server's identity by validating the certificate' and click 'OK'

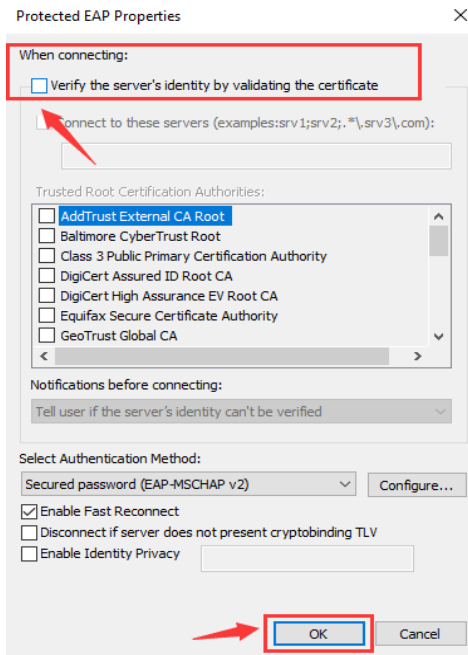

12. Choose 'Advanced settings'

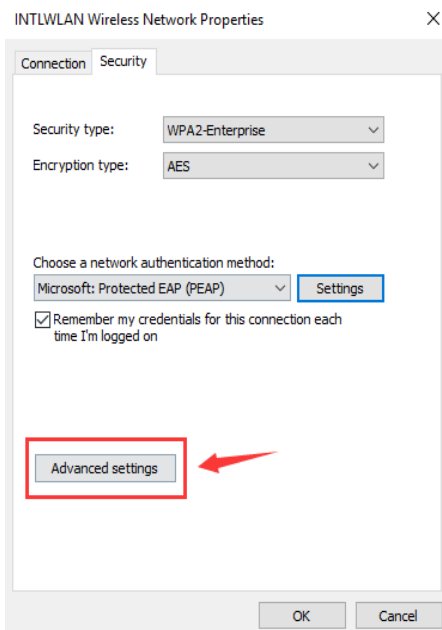

13. Click 'Specify authentication mode', choose 'User authentication' and 'Save credentials'

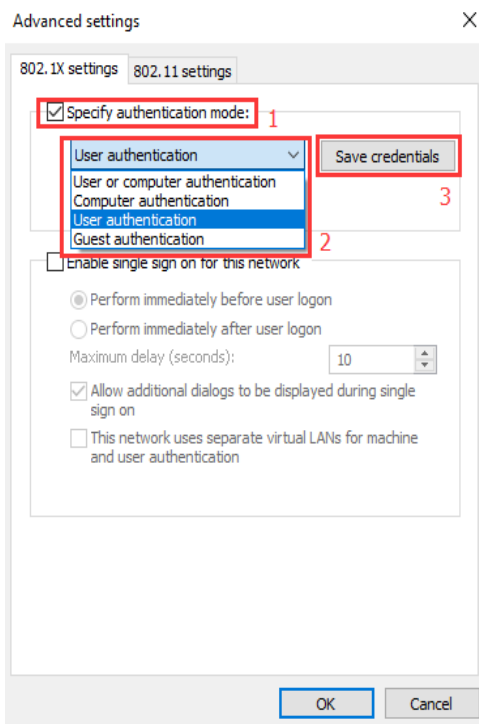

14. Successfully Connect eduroam after input your INTL ID and password in your 'credentials'.

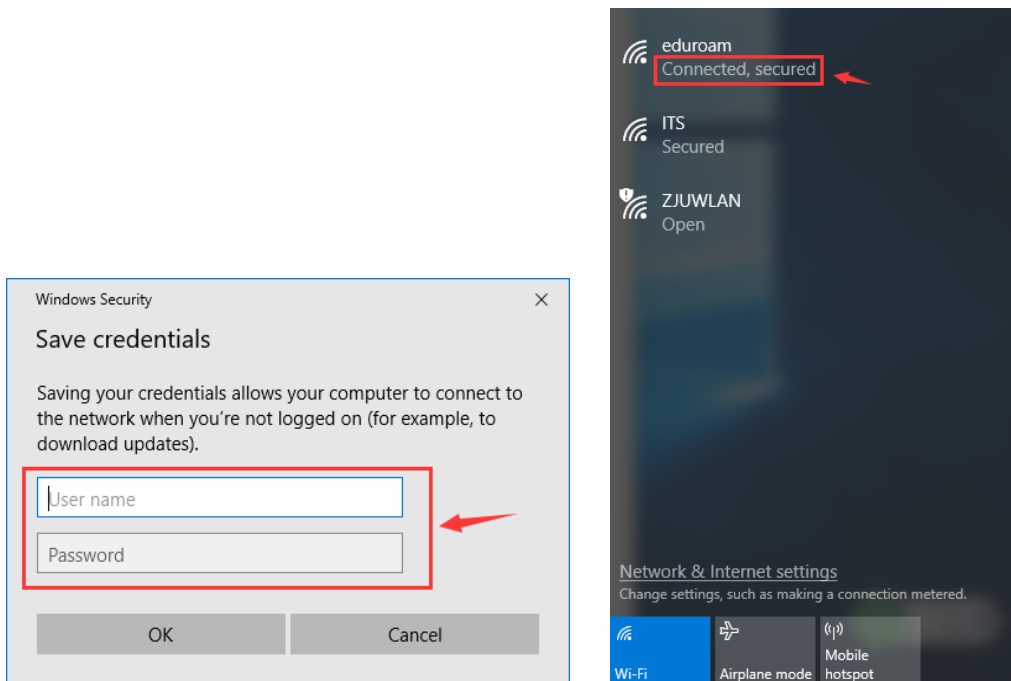

15. If credentials have been "saved" and your computer automatically logs in without prompting your to entering your INTL ID and Password you may have to "forget" your credentials before you can log in successfully. For example, if you change your password.

- Choose 'Network & Internet setting' in the task bar

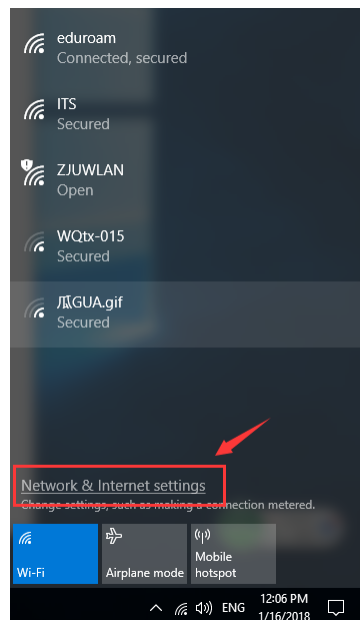

- Choose 'Wi-Fi' and choose 'Manage known networks'

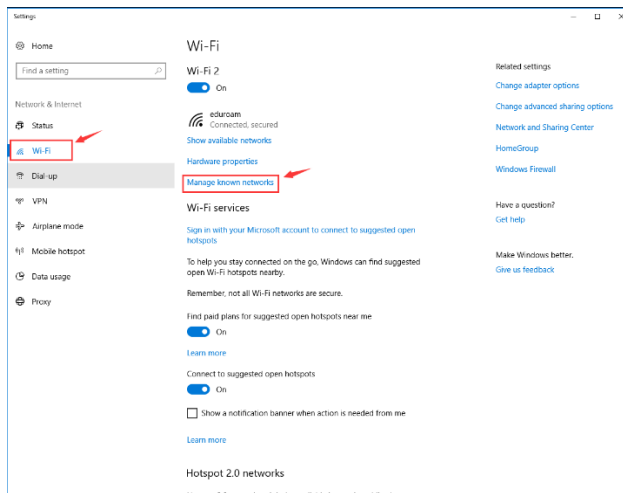

- Click 'Forget'

